

Type K7 channel block with kerb or Drop Kerb

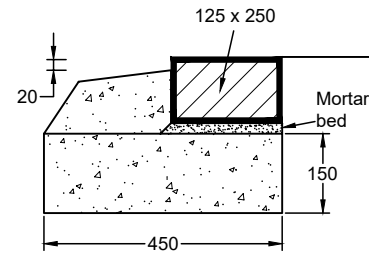

Type K8 channel block without kerb

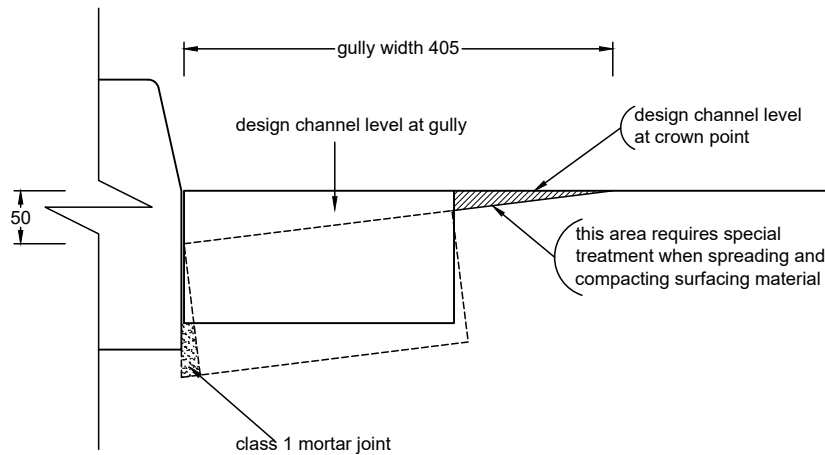

Enlargement for forced drainage

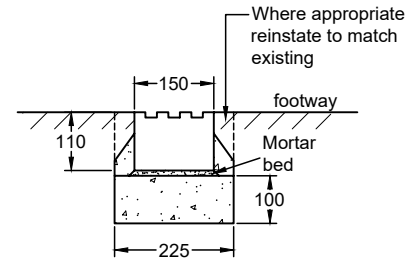

Type K9 concrete ribbed channel for transverse footway drainage

Notes

1. Precast concrete channel blocks 125 x 250mm to BS 340.
2. Mortar bed and joint to be Class 1 to Clause 2404 bed thickness 10-20mm to Clause 1101.
3. Forced drainage only used where gradient less than 0.66%.
4. For kerb detail see drawing No. SD/11/2.
5. Concrete grade ST3 to Clause 2602.
6. Concrete ribbed channels to be Marshalls/Charcon type 150 x 110 x 915 or similar approved.
7. Joints between adjacent blocks to be pointed with Class 1 mortar to Clause 2404.
8. The measurement of ribbed channels shall be in accordance with the method of measurement for Highway Works.
9. Matching grooves to be cut in top of kerb.

Rev:	Date:	Description:	Approved by:
AMENDMENT DETAILS			



Checked by:	GP	Approved by:	SB
-------------	----	--------------	----

ISSUED 12/05/17

Precast Channel Blocks and Ribbed Channel for Footway Drainage

This is a typical detail and may require conversion to a full scheme specific drawing.

NOT TO SCALE  
(all units in millimetres)

**Disclaimer :** Before making use of this detail, any designer or third party must ensure that it satisfies all requirements of the scheme to which it is being applied. Lincolnshire County Council accept no responsibility for third party use of this Standard Detail.

**SD/11/1**  
Standard Detail Number

Revision Number