

Notes

1. No. of ducts, dimensions and depth of chamber to be as specified on duct layout drawing and/or scheme details.
2. 100mm concrete fillet shall be installed around frame where top of chamber in grass or loose surfaces.
3. Chambers in excess of 600mm x 600mm shall contain braces at 450mm intervals and ST4 concrete surround must be used
4. Step irons must be provided where deemed necessary

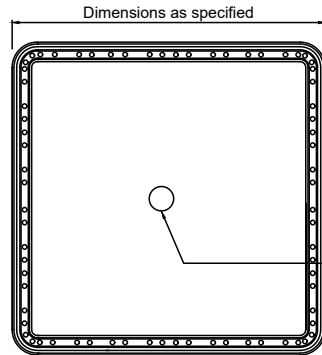

Twin walled pre-formed interlocking injection moulded plastic segments modular in construction - c/w vertical stiffeners  
Designed to meet requirements of BSEN124 40 tonne loading minimum

3D View of Chamber Section

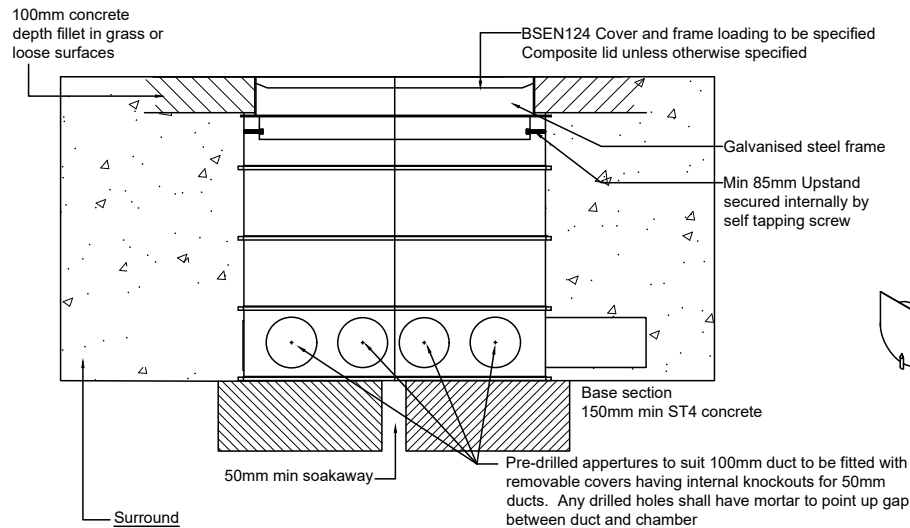
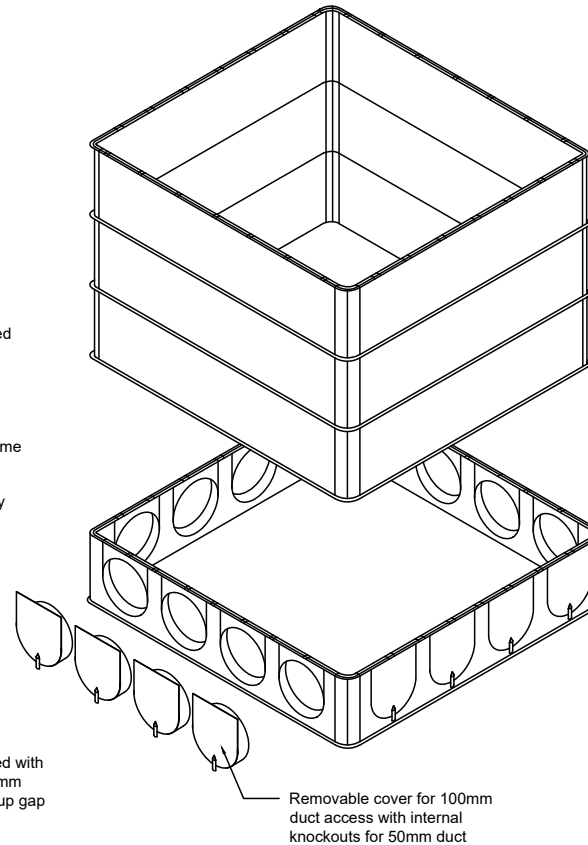

**Surround Footway**  
Minimum suitable as dug compactable material or 150mm ST4 concrete or compacted granular sub base Type 1  
**Carriageway**  
Minimum 150mm ST4 concrete

Rev:	Date:	Description:	Approved by:
A1	22/03/19	Surfacing note amended Note added re frame fixings	PC
AMENDMENT DETAILS			



Checked by:	PC	Approved by:	SB
ISSUED		04/12/14	

Sectional Footway Access Chamber

This is a typical detail and may require conversion to a full scheme specific drawing.

NOT TO SCALE  
(all units in millimetres)

**Disclaimer :** Before making use of this detail, any designer or third party must ensure that it satisfies all requirements of the scheme to which it is being applied. Lincolnshire County Council accept no responsibility for third party use of this Standard Detail.

SD/14/6B  
Standard Detail Number

A1  
Revision Number